

# Ledex® Low Profile Size 6ECM — Push or Pull

Medium Stroke, Conical Face  
Part Number: 282352-0XX

All catalogue products manufactured after April 1, 2006 are RoHS Compliant

## Performance

Maximum Duty Cycle	100%	50%	25%	10%
Maximum ON Time (sec) when pulsed continuously <sup>1</sup>	∞	87	36	13
Maximum ON Time (sec) for single pulse <sup>2</sup>	∞	140	44	16
Watts (@ 20°C)	32	64	128	320
Ampere Turns (@ 20°C)	1480	2080	2940	4620

Coil Data			VDC	VDC	VDC	VDC
awg (0XX) <sup>3</sup>	Resistance (@20°C)	# Turns <sup>4</sup>	(Nom)	(Nom)	(Nom)	(Nom)
23	4.69	567	12.3	17.2	24.0	38.0
24	7.43	710	15.5	22.0	31.0	48.0
25	12.90	960	19.9	28.0	39.0	62.0
26	19.70	1170	25.0	35.0	49.0	78.0
27	32.00	1500	32.0	44.0	63.0	99.0
28	51.60	1904	40.0	56.0	79.0	125.0
29	74.40	2232	49.0	69.0	98.0	154.0
30	126.00	2940	63.0	89.0	126.0	198.0
31	195.00	3611	80.0	112.0	159.0	250.0
32	288.00	4350	98.0	138.0	195.0	306.0
33	427.00	5010	126.0	177.0	251.0	394.0

- <sup>1</sup> Continuously pulsed at stated watts and duty cycle
- <sup>2</sup> Single pulse at stated watts (with coil at ambient room temperature 20°C)
- <sup>3</sup> Other coil awg sizes available — please consult factory
- <sup>4</sup> Reference number of turns

## Specifications

Dielectric Strength	23-31 awg, 1200 VRMS ; 32-33 awg, 1500 VRMS
Recommended Minimum Heat Sink	Maximum watts dissipated by solenoid are based on an unrestricted flow of air at 20°C, with solenoid mounted on the equivalent of an aluminium plate measuring 314 mm square by 3.2 mm thick
Coil Resistance	23-33 awg, ±5%
Weight	609.5 g
Holding Force	218.0 N @ 105°C
Dimensions	See page G18

## How to Order

Add the coil awg number (0XX) to the part number (for example: to order a 25% duty cycle unit rated at 63 VDC, specify 282352-027).

Please see [www.ledex.com](http://www.ledex.com) (click on Stock Products tab) for our list of stock products available through our distributors.

LINEAR Low Profile

Size 6ECM— Typical Force at 20°C

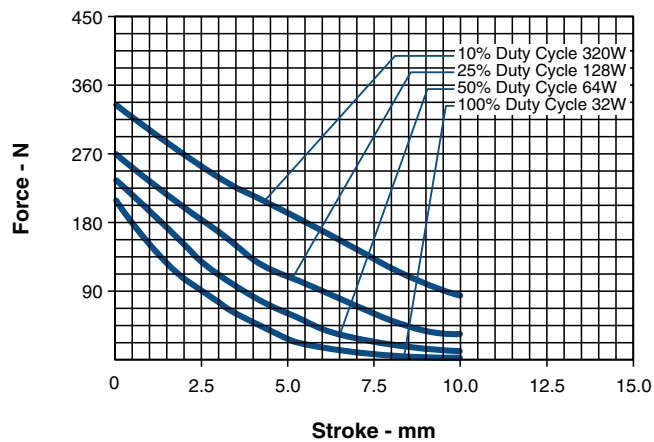

Size 6ECM— Typical Speed @ No Load, 20°C

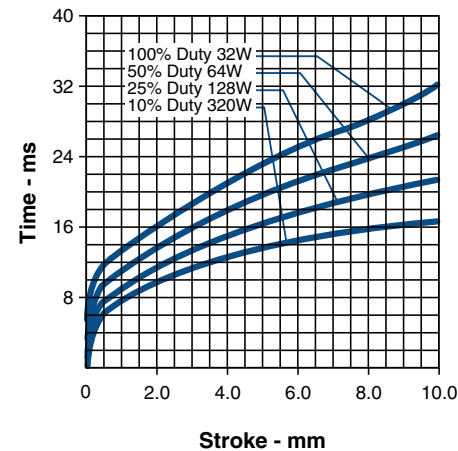

Force values for reference only.

All specifications subject to change without notice.

# Ledex® Low Profile Dimensions

mm

All solenoids are illustrated in energised state

Size 6SFM

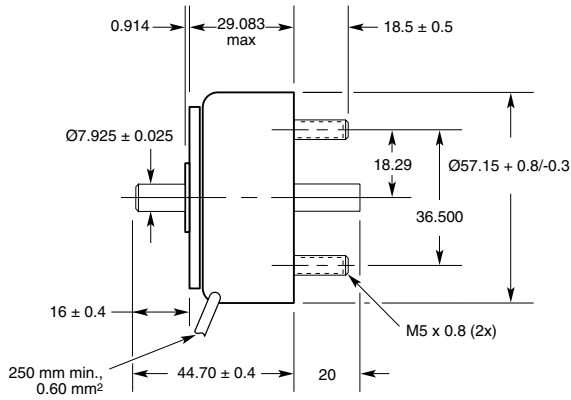

Size 6ECM

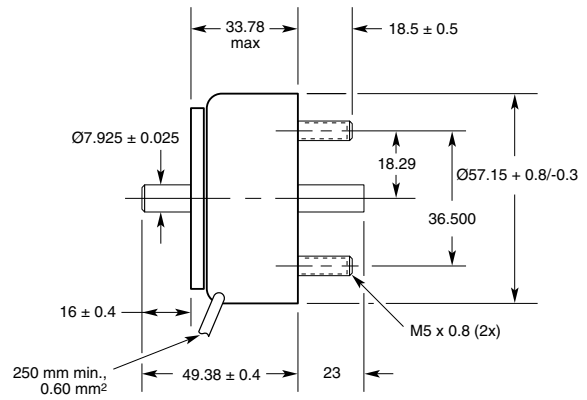

LINEAR Low Profile

Size 7ECM

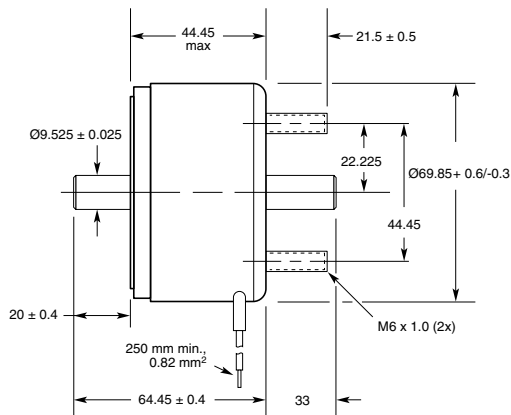

Size 8ECM

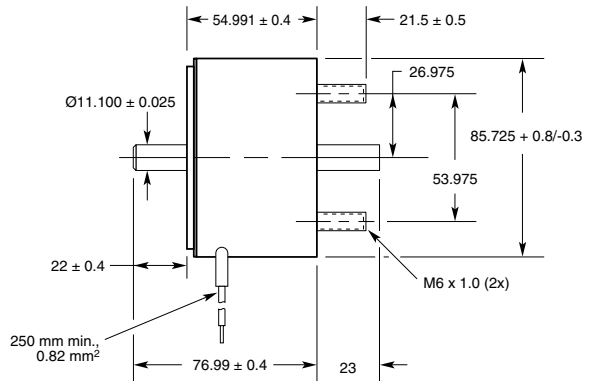

All specifications subject to change without notice.