

Characteristics:

High Power DC motor

Specifications:

Dimensions	: Ø 27.5 X 46.5 mm
Shaft Diameter	: Ø 2.305 mm
Input Voltage	: 28.0 V DC
No Load Speed	: 19000 rpm
No Load Current	: 0.20 A
Nominal Speed	: 16000 rpm
Nominal Torque	: 22.00 mNm
Nominal Current	: 1.80 A
Stall Torque	: 140.00 mNm
Stall Current	: 10.00 A
Maximum Output Power	: 70.00 W
Maximum Efficiency	: 75 %
Torque at Maximum Efficiency	: 15.00 mNm
Speed at Maximum Efficiency	: 17000 rpm
Life (typical)	: 175 hr
Weight	: 100 g
Operation Temperature	: -10 to 55 °C
Storage Temperature	: -20 to 80 °C
Electrical Connection	: terminals

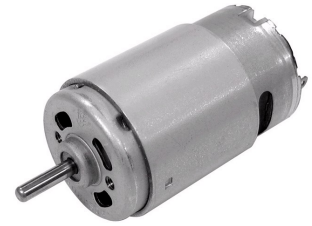

Performance Data:

	No Load	Stall	Max Efficiency	Max Power
Current (A)	0.20	10.00	1.30	5.50
Efficiency (%)	-	-	75	45
Output Power (W)	-	-	30.00	70.00
Speed (rpm)	19000	-	17000	9400
Torque (mNm)	-	140.00	15.00	70.00

Application Examples:

Hair Dryers

Drawing:

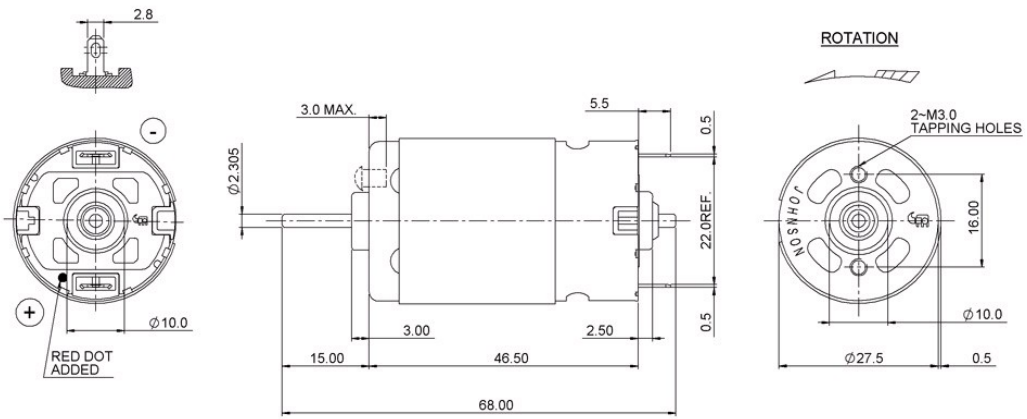

Performance Curves:

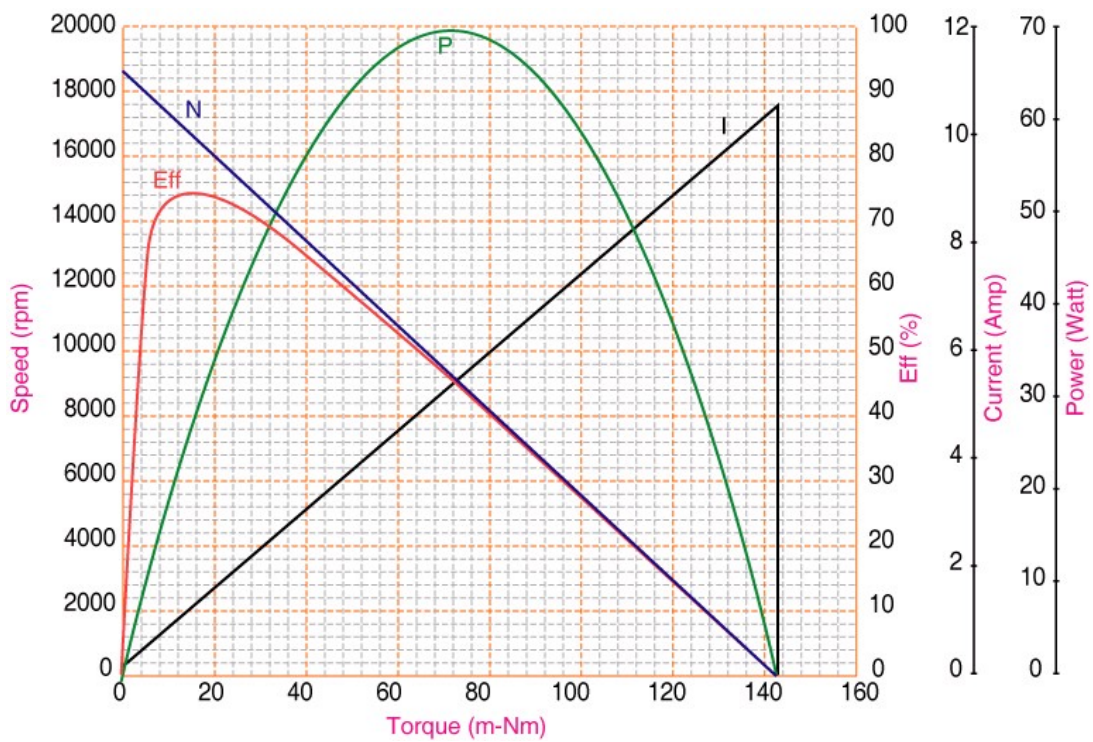

Units in Metric