

# V 250

preliminary

## Gearboxes

### V 250

Dimensions (mm)	70 x 30
Hight (mm)	36
Max. torque (cNm)	2500
Ratios	37 1/2 ... 1500
Internal slipping clutch	—
Standart shaft (mm)	∅ 12 x 35
Motor combination	5021–, 5022–, 5032 RG–, 6443–, 6444– series



### Standard Data

Mounting	any position
Max. input speed *	3000 min <sup>-1</sup>
Max. output torque *	2500 cNm
Average back lash	1,5°
Max. axial force F <sub>A</sub>	60 N
Max. lateral force, up 20 mm flange F <sub>e</sub>	80 N
Max. axial play	0,3 mm
Ambient temperature operation	–20 ... +80 °C
Ambient temperature storage	–40 ... +100 °C

Ratio	37 1/2	62 1/2	150	187 1/2	375	750	1500
-------	--------	--------	-----	---------	-----	-----	------

\* Depends on ratio

### Order Reference

Type	Gearbox	VK 4	6 1/4	1
Ratio	37 1/2			
Shaft type	1	see drawings Dimensions shaft		
	2			
	3			
	4			
optional	motor pinion: on request			

Technical Data

Ratio	Stages *	$\eta$
37 <sup>1</sup> / <sub>2</sub>	3	0.73
62 <sup>1</sup> / <sub>2</sub>	4	0.65
150	4	0.65
187 <sup>1</sup> / <sub>2</sub>	4	0.65
375	5	0.59
750	5	0.59
1500	5	0.59

\* Direction of rotation of output- and motor-shaft at  
 2, 4 and 6 stages - same  
 3 and 5 stages - opposite

Dimension Shaft

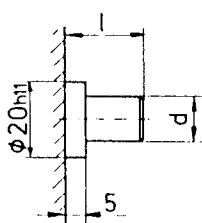

Picture 1

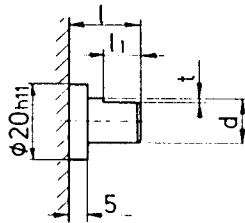

Picture 2

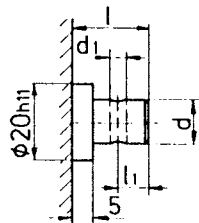

Picture 3

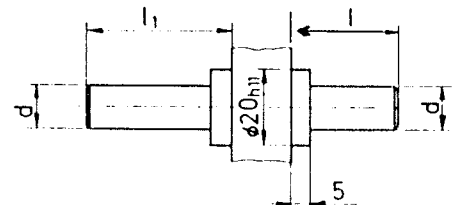

Picture 4

Picture	Type	d	l	l1	t	d1
1	A	12h8	40			
1	B	12h8	30			
2	C	12h8	40	15	1	
2	D	12h8	30	5	1	
3	E	12h8	40	20		4h12
4	F	12h8	40	38		

Dimensions

